

Trusted. Tested. Tough.™

Product information presented here reflects conditions at time of publication. Consult factory regarding discrepancies or inconsistencies.



SECTION: Z4.10.240
ZM2424
0218
Supersedes
0916

MAIL TO: P.O. BOX 16347 • Louisville, KY 40256-0347
SHIP TO: 3649 Cane Run Road • Louisville, KY 40211-1961
(502) 778-2731 • 1 (800) 928-PUMP • FAX (502) 774-3624

visit our web site:
zoellerengprod.com

THE SHARK Series

PROGRESSING CAVITY GRINDER PUMP

FEATURES:

- Finned Class 30 Cast Iron Construction
- Corrosion Resistant Powder Coated Epoxy Finish
- Discharge Size - 1-1/4" NPT
- 1 & 2 HP, 60 Hz, 1750 RPM
Model 7020 - 1 HP, 230 Volts/1 Ph
Model 7021 - 2 HP, 230 Volts/1 Ph
- UL Listed 20 ft. 3-wire neoprene cord with 15 amp plug
- Oil-Filled - Hermetically Sealed Motor with Class B Windings
- Hardened Stainless Steel Cutter and Disc, Rockwell C55-60
- Stainless Steel Hydraulic Pump Rotor
- Pressure Relief Valve
- Upper and Lower Ball Bearing Construction
- Carbon/Ceramic mechanical seal
- Viton Square Rings and Gasket
- Integral Thermal Overload Protection with Automatic Reset
- SS Mounting Stand for free standing installation
- Preassembled Systems Available

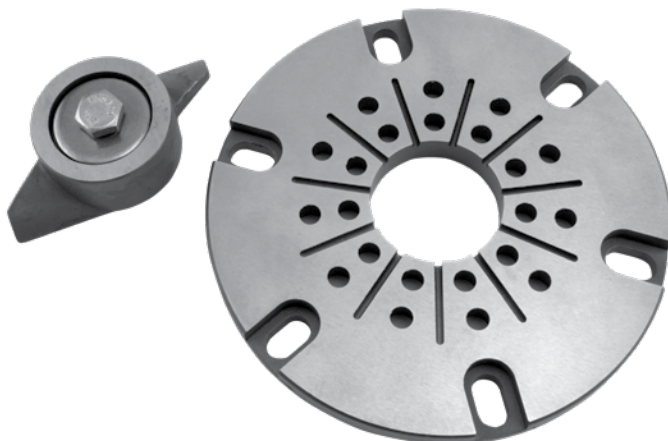

7020 & 7021 SERIES PROGRESSING CAVITY GRINDER PUMP MODELS

7020 - 1 HP
7021 - 2 HP



Tested to UL Standard UL778
& Certified to CSA
Standard C22.2 No. 108



Product may not be exactly as pictured.

GRINDER SYSTEMS

(A) GRINDER

STANDARD FEATURES:

- 1-1/4" NPT Discharge
- Carbon/Ceramic Tandem Seals
- Thermal Overload protection
- Hydraulic SS Rotor and Buna-n Stator
- Stainless Steel Cutter Plate / Cutter
- Stainless Steel Shaft
- Stainless Steel Hardware
- Viton Square Rings and Gasket
- Corrosion resistant powder coated epoxy paint
- 20 ft. Power Cord Cord

OPTIONS:

- 25' Long Cords
- 35' Long Cords
- 50' Long Cords

(A) 7020 & 7021 PROGRESSING CAVITY GRINDER 1 OR 2 HP 1-1/4" N.P.T. DISCHARGE

P/N	WGT.	MODEL	VOLTS	PH	HP	AMP
<input type="checkbox"/> 7020-0004	88	E7020	230	1	1	7.0
<input type="checkbox"/> 7021-0004	91	E7021	230	1	2	10.5

Maximum operating temperature 130 °F (54 °C).

CAUTION To ensure proper pump operation, a swing or flapper style check valve must be installed in the pump discharge line. A faulty or non-functional check valve when combined with a pressure sewer may prevent the pump from starting.

Note: All variable level float switches in this section are mechanically activated and do not contain mercury.

ELECTRICAL - CONTROL / ALARM / FLOATS / JUNCTION BOX (SELECT 1 OF THE 3 COLUMNS)

QWIK BOX w/ FLOAT SWITCH

(B) ALARM PANEL

- P/N 10-0623 Indoor/Outdoor high water alarm with 15' control switch.
- P/N 10-0126 NEMA 4X high water alarm with 15' control switch and dry contact.
- P/N 10-4012 Indoor high water alarm with 15' control switch.

(C) PUMP SWITCH & WEIGHT - 1 pump switch required

Single piggy-back type 230 volt 13 amp

- P/N 10-0035 with 15' cord
- P/N 10-0689 weight for alarm float (Indoor Systems only)

(D) JUNCTION BOX - 1 required

- P/N 10-0580 Qwik-Box, NEMA 4X with 230 volt receptacle

PLUGGER PANEL

(B) CONTROL PANEL

- P/N 10-2006 Plugger panel, NEMA 4X with high water alarm and 230 volt receptacle.

(C) FLOAT SWITCHES - 2 required

Pump: One pump switch
Alarm: One control switch

- P/N 10-0706 piggy-back pump switch with 20' cord
- P/N 10-0311 piggy-back pump switch with 25' cord
- P/N 10-1956 piggy-back pump switch with 35' cord
- P/N 10-0744 mechanical control switch with 20' cord
- P/N 10-1877 mechanical control switch with 25' cord
- P/N 10-1878 mechanical control switch with 35' cord

(D) JUNCTION BOX

J-Box not recommended with this type control.

SIMPLEX PANEL

(B) CONTROL PANEL

- P/N 10-1212 Simplex panel, NEMA 4X, with high water alarm and pump circuit breaker, less float switches.

(C) FLOAT SWITCHES - 2 required

Pump: One pump switch
Alarm: One control switch

- P/N 10-0706 piggy-back pump switch with 20' cord
- P/N 10-0311 piggy-back pump switch with 25' cord
- P/N 10-1956 piggy-back pump switch with 35' cord
- P/N 10-0744 mechanical control switch with 20' cord
- P/N 10-1877 mechanical control switch with 25' cord
- P/N 10-1878 mechanical control switch with 35' cord

(D) JUNCTION BOX - optional

- P/N 10-2145 NEMA 4X with 3 cord seals and conduit connection.

(E) INDOOR AND OUTDOOR PACKAGED SYSTEMS - PUMP & CONTROLS NOT INCLUDED

INDOOR SYSTEM

FIBERGLASS BASIN

Pump suspended from steel cover

P/N 32-0029 24" X 36"

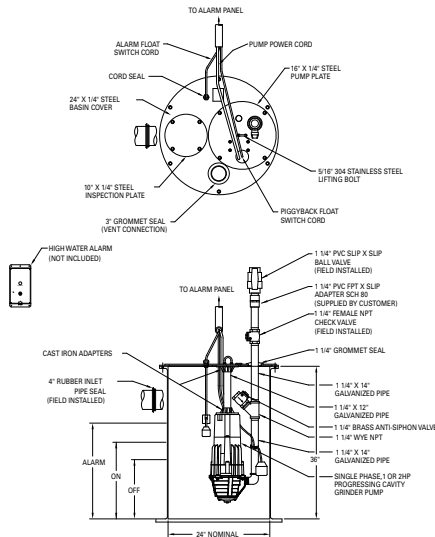

SK2628

- Fiberglass Basin
- Rust Resistant Steel Cover (epoxy coated)
- Inspection Plate
- Pump Plate
- 3" Adaptaflex Vent Seal
- 1-1/4" Adaptaflex Discharge Pipe Seal
- Cord Seal
- 1-4" Rubber Inlet Pipe Seal - Field Installed
- Pump Support Hardware
- 1-1/4" Brass Anti-siphon Device
- 1-1/4" NPT Brass Check Valve
- Ball Valve

OUTDOOR SYS. w/ FLEX HOSE DC

FIBERGLASS BASIN & COVER 1.25" FLEXIBLE HOSE w/ DISCONNECT

P/N 35-0006 24" X 48"

P/N 35-0007 24" X 60"

P/N 35-0008 24" X 72"

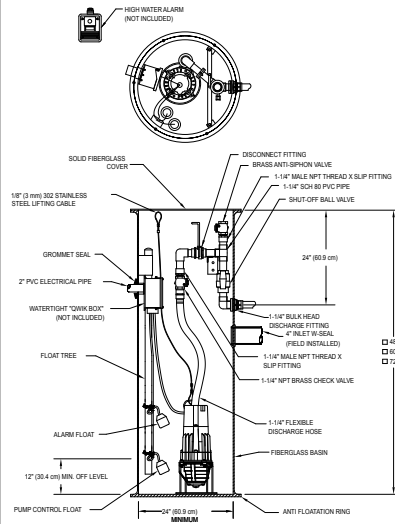

SK2540

- Fiberglass Basin with Anti-flotation Ring
- Flex-hose Discharge Assembly with Disconnect Fitting
- 1-1/4" PVC Discharge Pipe from Disconnect
- 1-1/4" Adaptaflex Discharge Pipe Seal
- 1' Pull Rod
- 8' SS Lifting Cable
- 1-1/4" PVC Ball Valve(s)
- 1-1/4" Brass Check Valve(s)
- 1-1/4" Brass Anti-siphon Device
- PVC Float Tree
- 1-4" Rubber Inlet Pipe Seal (Field Inst.)
- Fiberglass Cover

OUTDOOR SYSTEM w/ Z-Rail®

FIBERGLASS BASIN & COVER Z-RAIL® DISCONNECT SYSTEM

P/N 33-1598 24" x 60"

P/N 33-1597 24" x 72"

P/N 33-1594 24" x 84"

P/N 33-1596 24" x 96"

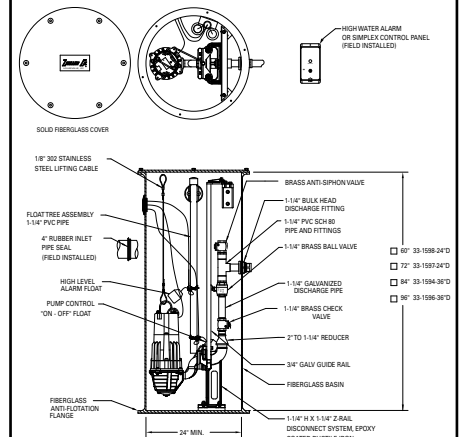

SK3091

- Fiberglass basin with anti-flotation ring
- 1-1/4" Schedule 80 PVC discharge piping
- 1-1/4" H x 1-1/4" Z-rail® P/N 39-0137 disconnect system, epoxy coated ductile iron
- 3/4" Galvanized rail pipes
- Stainless steel lifting cable
- 1-1/4" brass ball valve
- 1-1/4" brass check valve
- Anti-siphon device
- PVC float tree
- 1-4" rubber inlet pipe seal (field inst.)
- 1-2" pipe seal (field inst.) for electrical conduit
- Solid fiberglass cover with Zoeller imprint

(F) ACCESSORIES FOR FIELD ASSEMBLED SYSTEMS

FLEX-HOSE DISCHARGE ASM.

P/N 10-2038 w/30" hose

Z-RAIL® DISCONNECT SYSTEM

- P/N 39-0137 - Ductile iron
- P/N 39-0138 - Ductile iron w/ stainless steel support bracket
- P/N 39-0139 - Stainless steel stabilizer bracket

SS LIFTING CABLES AND ROD

- P/N 39-0031 8' Cable
- P/N 39-0032 12' Cable
- P/N 39-0069 1' Rod

PREWIRED CONDUIT (10-0580 Qwik Box Required)

- 5100-0016 - 25'
- 5100-0017 - 35'
- 5100-0018 - 50'

GALVANIZED 1.25" DISCHARGE ELBOW

P/N 018386

CHECK VALVE

P/N 30-0223 1.25" NPT Brass

BALL VALVE

P/N 30-0165 1.25" PVC

PREPACKAGED AND JOB READY SYSTEMS

INDOOR

REQ.

1 7020 or 7021 Grinder	P/N _____ (A)
1 Alarm Panel	P/N _____ (B)
1 Piggyback Pump Switch	P/N _____ (C)
1 Weight for Alarm Float	P/N _____ (C)
1 Basin, Cover and Hardware	P/N _____ (E)

OUTDOOR

REQ.

1 7020 or 7021 Grinder	P/N _____ (A)
1 Control Panel/Alarm System	P/N _____ (B)
1 Piggyback Pump Switch	P/N _____ (C)
1 Control Switch (if required)	P/N _____ (C)
1 Junction Box (optional)	P/N _____ (D)
1 Package Basin Assembly	P/N _____ (E)

FIELD MOUNT SYSTEMS

REQ.

1 7020 or 7021 Grinder	P/N _____ (A)
1 Control Panel / Alarm System	P/N _____ (B)
1 Piggyback Pump Switch	P/N _____ (C)
1 Control Switch (if required)	P/N _____ (C)
1 Weight for Alarm Float (if required)	P/N _____ (C)
1 Junction Box (Optional)	P/N _____ (D)
1 Optional Accessories	P/N _____ (F)
	P/N _____ (F)
	P/N _____ (F)

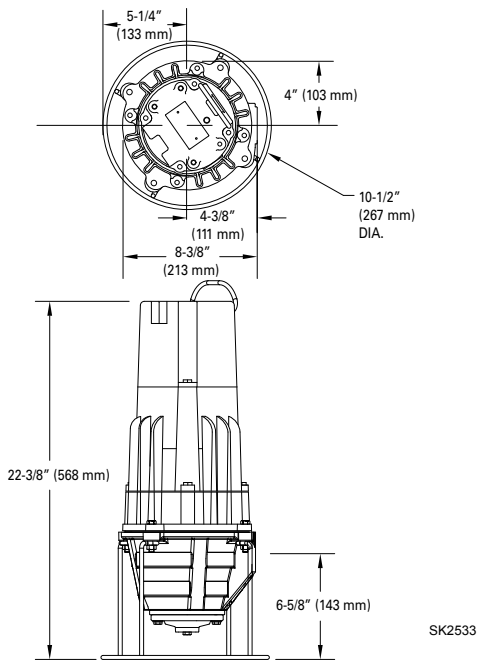
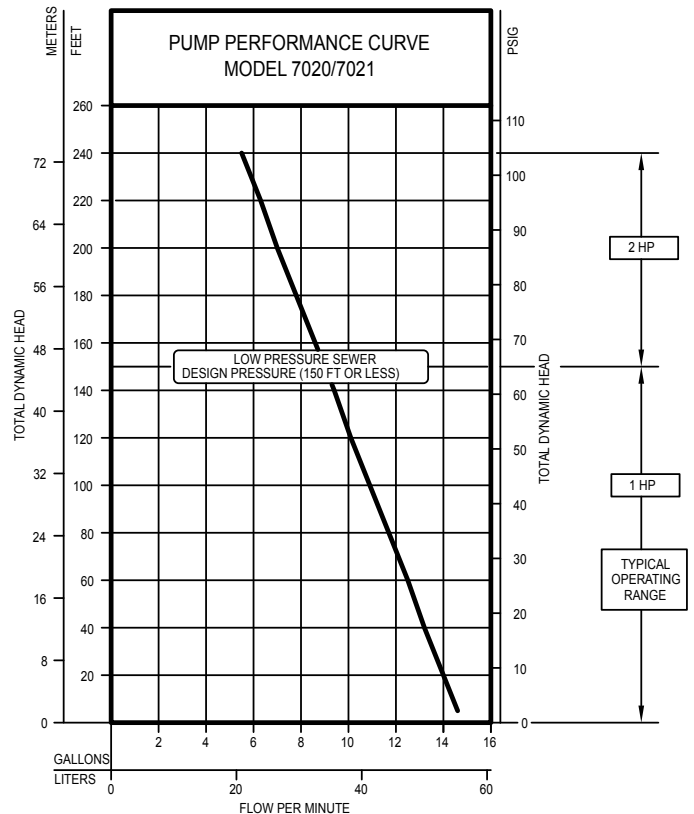

MAIL TO: P.O. BOX 16347 • Louisville, KY 40256-0347
 SHIPTO: 3649 Cane Run Road • Louisville, KY 40211-1961
 (502) 778-2731 • 1 (800) 928-PUMP • FAX (502) 774-3624

Trusted. Tested. Tough.™

visit our web site:
zoellerengprod.com